

MOUNTING DETAIL FOR WALLS OVER 4-3/4' THICK

MOUNTING DETAIL FOR WALLS UP TO 4-3/4' THICK

REFERENCE DRAWINGS	
1820 -SW Wall Sleeve	9925-291-001
Mounting Hardware	9957-900-001

INSTALLATION INSTRUCTIONS:

WALLS OF MINIMUM THICKNESS OF 4-3/4"

A-HAND TIGHTEN (4) MOUNTING STUDS ① INTO NUTS ② ON BACK OF RECESSED SHELF ③. PLACE SHELF ③ IN WALL OPENING.

B-FROM CHASE SIDE, PLACE BACK PLATE ④ OVER STUDS ①. SCREW NUTS ⑤ ONTO STUDS ①, & TIGHTEN. NOTE: DO NOT EXCEED 6.5 FT/LBS MAX. TORQUE ON MOUNTING NUTS ⑤.

WALLS OF MAXIMUM THICKNESS OF 4-3/4"

A-HAND TIGHTEN (4) MOUNTING STUDS ① INTO NUTS ② ON BACK OF RECESSED SHELF ③. PLACE SHELF ③ IN WALL OPENING.

B-FROM CHASE SIDE, PLACE BACK PLATE ④ OVER STUDS ①. SCREW NUTS ⑤ ONTO STUDS ①. THREAD 1/2" STUDS ⑥ THRU PLATE ④ & TIGHTEN AGAINST WALL TO SECURE SHELF ③.



ACORN ENGINEERING COMPANY
P.O. BOX 3527 INDUSTRY, CA. 91744
(626) 336-4561 FAX (626) 961-2200

TITLE RECESSED SHELF, REAR MOUNTED, CAT #1820		
MANUFACTURE DATE DECEMBER 1971 TO PRESENT	DATE ISSUED 4/11/97	DRAWING NUMBER 9925-134-001
	DATE REVISED	



BOTH VIEWS ARE FROM CELL SIDE.
 SHADED AREAS ARE REQUIRED WALL OPENINGS OR
 BLOCKOUTS.

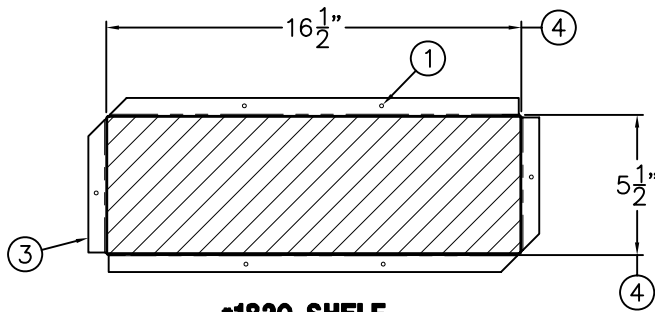

#1820 SHELF
 -SW WALL SLEEVE

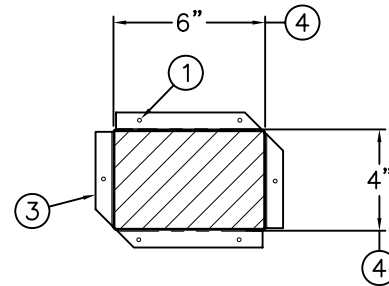

#1832 RECESSED SOAP DISH
 -SW WALL SLEEVE

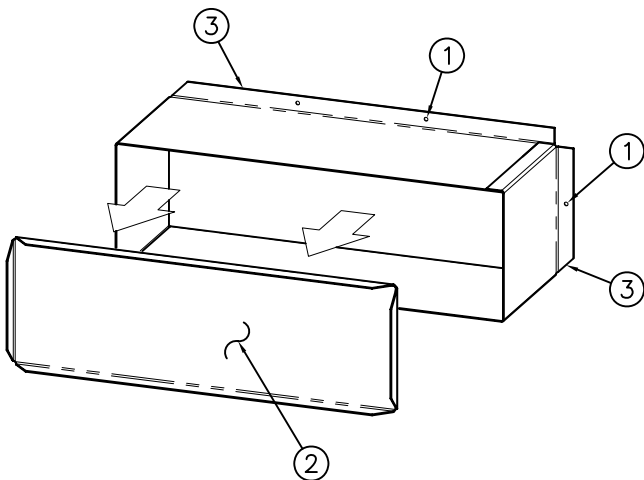

INSTALLATION INSTRUCTIONS:

SLEEVES ARE INSTALLED IN FORMS USING NAIL HOLES
 ① PROVIDED OR GROUTED INTO BLOCK WALLS BECOMING
 A PERMANENT PART OF THE WALL.

NOTE: FOR POURED WALL CONSTRUCTION, TEMPORARY
 BRACING SHOULD BE INSTALLED WITHIN OPENING TO
 PREVENT DEFORMATION TO SLEEVE WHICH MAY OCCUR
 DURING POUR. DO NOT POUR CONCRETE DIRECTLY ON TOP
 OF WALL SLEEVE. THE OPENING IS CAPPED; THIS CAP ②
 MUST BE REMOVED FROM THE CHASE SIDE OF THE WALL
 SLEEVE BEFORE INSTALLING SHELF OR RECESSED SOAP DISH.

A- INSTALL SLEEVE AT DESIRED CELL SIDE HEIGHT WITH
 FLANGE ③ ON CHASE SIDE OF WALL.

B- USE BLOCKOUT DIMENSIONS ④ WHEN SLEEVES ARE NOT
 AVAILABLE.

ACORN ENGINEERING COMPANY
 P.O. BOX 3527 INDUSTRY, CA. 91744
 (626) 336-4561 FAX (626) 961-2200

TITLE -SW WALL SLEEVE FOR #1820 & #1832		
MANUFACTURE DATE DECEMBER 1971 TO PRESENT	DATE ISSUED 03/01/90	DRAWING NUMBER 9925-291-001
	DATE REVISED 02/11/09	